

STEP 1

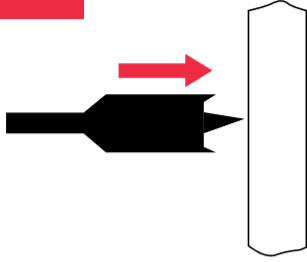

- We recommend using a cable finder to detect any existing cables behind the drywall
- Mark out the hole centre with a pencil or marking tool
- Using a 20mm diameter spade bit, drill a hole

IMPORTANT: Only apply a gentle pressure whilst drilling to avoid damaging the rear of the drywall.

Bullfix Extra fixings are designed to be used with standard (1/2" - 5/8") thickness drywall attached to stud partition walls. To operate properly they require a minimum cavity depth of 25/32" (with shallower cavities the fin tails will not be able to open properly).

STEP 2

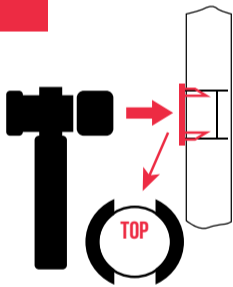

- Insert the collar and gently tap with a mallet

STEP 3

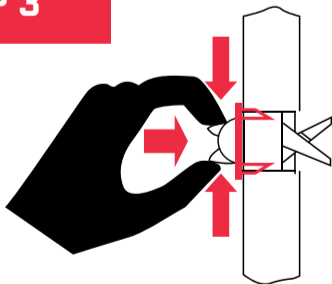

- Push the closed fixing gently through the collar with the fin tails aligned vertically
- Pinch the projected fin tails together

STEP 4

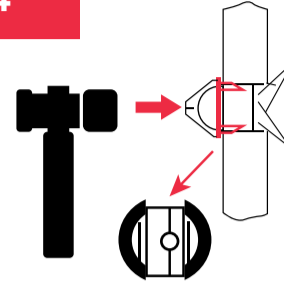

- Tap the rear of the fixing until the two halves of the fixing hole align to accept a screw.

IMPORTANT: If the drywall is more than 1/2" thick the fixing may slide into the collar, this is normal. You may also need to tap a little harder the thicker the drywall.

STEP 5

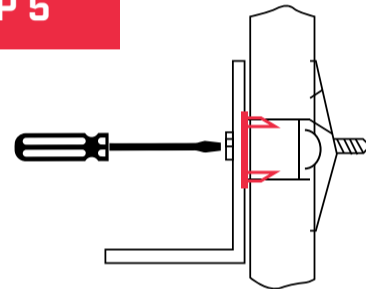

- Attach the object to the wall using the screws provided or any standard 5mm (No 10) screws
- To maximise performance, the screw should be long enough to reach the back of the fixing. If not, a longer screw should be used.
- To achieve the very maximum load capacity in drywall which is more than 1/2" thick, we recommend using washers to fill the gap between the front faces of the fixing and the drywall.



IMPORTANT: We do not recommend using screws that travel more than 36mm past the front surface unless you know the cavity is deeper.

SCAN HERE FOR AN INSTRUCTIONAL VIDEO:



Maximum load strengths are dependent on drywall thickness, humidity and brand. Please refer to the datasheet for more information.

WE DO NOT RECOMMEND USING BULLFIX FOR TV MOUNTS WITH A CANTILEVER OR EXTENDABLE ARM AS WE CANNOT GUARANTEE THE RELIABILITY. IDEAL FOR USE WITH A FIXED OR TILTING TV BRACKETS.

	Bullfix Extra Fixing	Bullfix Universal Fixing
		
Maximum recommended Tension Load (5/8" Standard Drywall)	108 lbs	132 lbs
Maximum recommended Tension Load (1/2" Standard Drywall)	81 lbs	100 lbs
Maximum recommended Shear Load (5/8" Standard Drywall)	255 lbs	293 lbs
Maximum recommended Shear Load (1/2" Standard Drywall)	227 lbs	216 lbs
Maximum recommended Cantilever Load @ 150mm (5/8" Standard Drywall)	74 lbs	99 lbs
Maximum recommended Cantilever Load @ 150mm (1/2" Standard Drywall)	63 lbs	85 lbs
Minimum Cavity Required	1/4"	25/32"
Compatible Screws	No 10 thread	No 10 thread

1. Maximum recommended loads apply to standard drywall in a dry condition. Please note that variations in board mounting, moisture content, drywall brand or physical condition of board can adversely effect load bearing performance. Continuous and repetitive loading / unloading on the fixing will weaken the drywall.
2. All recommended loads assume a minimum distance from the edge of the board of 2".
3. When using multiple fixings, to maintain the best performance for the fixing we would recommend you keep a minimum center distance of 3 3/4" between fixings.
4. For all maximum recommended loads required safety factors are considered.
5. Fixing Material - Glass Filled Nylon.

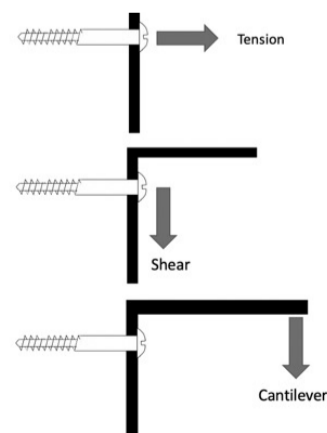

Rev B - Issue date 28/04/23

TV Mounting Brackets:

We do not recommend using Bullfix drywall fixings with TV mounting extendable arms. Any bracket that extends the center of gravity of any loading further than 150mm from the wall will risk exceeding the capability of the drywall fixing and in fact the drywall itself. We only recommend Bullfix drywall fixings for use with flat or tilting TV wall brackets.

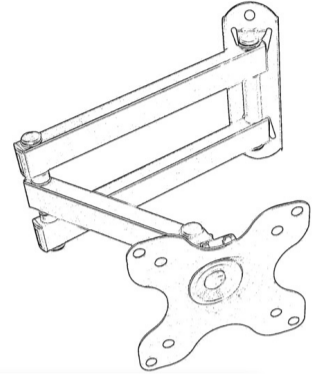
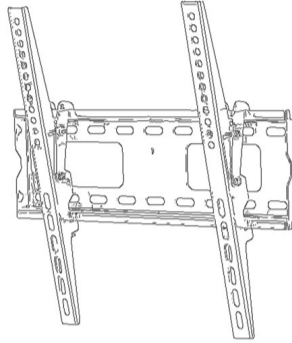
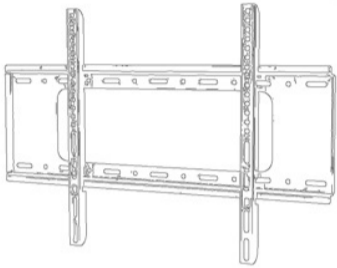

Radiator or Shelf Brackets:

We only recommend mounting items on drywall with Bullfix fixings using an appropriate bracket. The bracket should adhere to the specification shown below.

"Y" must be at least 1.5 times bigger than "X"

